

IAPMO ER-0829  
**TileVent | Aluminum Tape**

**METAL**

- Highly durable and weather resistant
- Maximum formability and long term functionality
- Fully recyclable

**IAPMO ER-0829**

- Passed Dade County wind driven rain test (PA100(A)-95)
- Passed ICC dust test (AC132)

**NET FREE AIRFLOW**

- 10.3 in<sup>2</sup> per running foot (9.5", 11", 13" & 15.75" width)

**HIGH QUALITY COLOR COATING**

- Durable UV resistant

**CONTINUOUS CORRUGATION**

- Stretching factor of 30%
- Conforms to roof surface
- Suitable for hip and ridge application
- Easy installation

**PERFORATED**

- Continuous air exhaust
- Reliable weather block

**BUTYL ADHESIVE SHEETS**

- Additional security against driving rain and snow

**TECHNICAL INFORMATION**

- Body: aluminum, corrugated and colored
- Thickness: .0057" with butyl adhesive strip
- Width: 9.5", 11", 13" and 15.75"
- Length: 25 ft./per roll
- Standard Colors: red and black

**WARRANTY**

- 25 year limited warranty



**FOR NEW CONSTRUCTION AND RETROFIT**

**USED ON: TILE ROOFS**

FOR RIDGE CROSS SECTION OR HIP

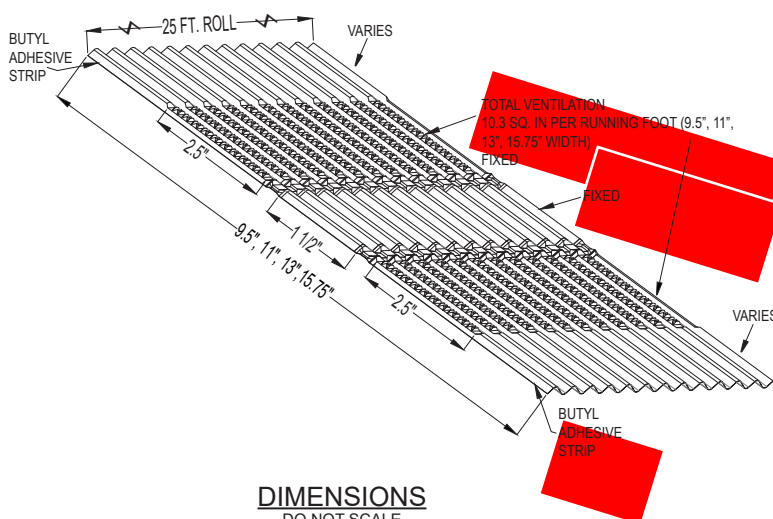
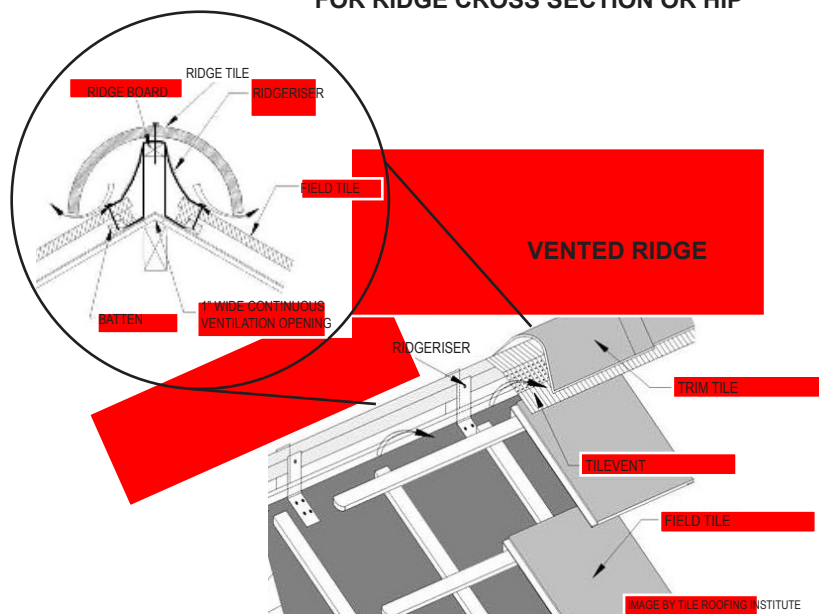

**DIMENSIONS**  
DO NOT SCALE

**INSTALLATION:** CENTER TILEVENT ON TOP OF ROOF NAILING BOARD. STAPLE OR NAIL THE TILEVENT EVERY 12 INCHES DOWN HIP OR RIDGE NAILING BOARD. FORM THE TILEVENT TO THE TILE ROOF SURFACE. BE CAREFUL THAT THE VENTILATION AREA DOES NOT PRESS TOO TIGHT TO THE SURFACE NAILING BOARD PREVENTING PROPER AIRFLOW. WHEN VENTING A HIP ON A TILE ROOF SYSTEM YOU CAN VENT FROM EAVE TO RIDGE. HOWEVER, WHEN VENTING THE ATTIC THROUGH A HIP YOU CAN ONLY CUT THE SHEATHING THE TOP THIRD OF THE HIP. REMOVE PROTECTIVE STRIP FROM ADHESIVE TAPE. PRESS TILEVENT IN PANS OF EACH TILE. TILEVENT CAN ELONGATE 30% FROM BARREL TO PAN. TAKE CARE THAT THE EDGE AREA OF THE TILEVENT IS THOROUGHLY PRESSED TO TILE. THE CORRUGATION OF THE TILEVENT SHOULD BECOME FLAT AS THE MATERIAL IS PRESSED INTO THE TILE. THEN USE A RUBBER ROLLER FOR OPTIMAL ADHESION. CUT OFF THE EXCESS AMOUNT OF THE TILEVENT AT THE END OF THE HIP OR RIDGE WITH A KNIFE OR SHEET METAL SHEARS. THE EXCESS MATERIAL CAN BE USED ON THE NEXT PROJECT.

**VENTILATION AND FLASHING SYSTEMS**

IAPMO ER-0829  
**TileVent | Aluminum Tape**

<b>ALUMINUM TAPE</b>			
STRUCTURE	Aluminum tape .0057" thick with color coating and butyl adhesive strips		
MATERIAL FRONT	Aluminum 99.5 (soft)		
MATERIAL CHARACTERISTICS	Lacquer		
	Quantity (dry)	0.4 - 0.5 oz/1.2 sq. yd.	
	Standard colors:	Red	(similar RAL 8004)
		Black	(similar RAL 9004)
	Gloss degree	unstressed	
	60° W:	35 +/- 5%	ECCAT 2
	Wear resistance	< 15% after 1.000 h QUVB	ECCAT 14
	Salt spray test	no damage after 1.000 h stress	ECCAT 9
	Distortion	minimum loss of gloss after 1.000 h stress	ECCAT 9
	Kesternich-test	no damage after 1.000 h stress	ECCAT 16
	T-bending:	T = 0.5 no cracks	ECCAT 7
	QUV-test (UVB 313)	remaining gloss < 5% after 1.000 h stress	ECCAT 3
<b>ADHESIVE STRIPS</b>			
STRUCTURE	Extruded strip of very tacky sealant/adhesive based on butyl rubber overed with a release film		
MATERIAL BACK SIDE	Butyl, Polyisobutylene		
MATERIAL CHARACTERISTICS (OUTSIDE)	Specific weight:	0.05 oz/0.03 fl. oz.	
	Temperature resistance:	continuously from -60°F - +200°F	
	Softening Point:	70<P>100 acc. NFP 85513 norm	
	Drying substance:	100%	
	Gravity resistance:	1.107 Pa at 4 in./min	
	Tearing off resistance:	0.233 Pa at 4 in./min	
	Elongation at break:	> 500%	
	Vapor resistance:	impermeable	
	Compatibility with paints:	no migration, no spotting	
	Resistance:	Water	excellent
		Sea Water	excellent
		House detergent	very good
Acid (diluted)		good	
Base (diluted)		very good	
Alcohol		average	
	Organic solvents	poor	